

FEATURES

- Close coupled 2-pc. HET toilet. Combination round front bowl and tank, less seat.
- 12" (305mm) rough-in.
- Vitreous china.
- High efficiency (1.28 gpf/4.8 Lpf). • Gravity feed, siphon action bowl.
- 2" fully-glazed trapway.
- 16-1/2" comfort height.
- Chrome trip lever.
- 2 color-matched bolt caps.
- 5 Year Limited Residential Warranty / 1 Year Commercial Warranty
- Meets strict flushing performance criterion established by the EPA (Environmental Protection Agency) WaterSense program
- High efficiency toilets use at least 20% less water than standard 1.6 GPF toilets
- This product can help a building earn Water Efficiency points in the LEED Green Building Rating System™

COLORS

- White

OPTIONS

- Tank with right-hand trip lever.

Specified Model

MODEL NO.	DESCRIPTION	Length	Width	Height
COMPLETE TOILET KITS				
SMBT-1550	Round Bowl & LH Tank	27½"	18⅞"	31⅞"
SMBT-1550-01	Round Bowl & RH Tank	27½"	18⅞"	31⅞"
INDIVIDUAL COMPONENTS				
SMB-1550	RoundFront Bowl	27½"	14"	16 ½"
SMT-1550	Toilet Tank - LH Trip Lever	8½"	18⅞"	15⅞"
SMT-1550-01	Toilet Tank - RH Trip Lever	8½"	18⅞"	15⅞"

Specified Model

01- White

Compliance Certifications - Meets or Exceeds the Following Specifications

- ASME A112.19.2M-2008/CSA B45.1-2008
- UPC®, National Plumbing Code of Canada, IPC & IRC
- EPA Water Sense Tank-Type High Efficient Toilet Specs



Meets the Americans with Disabilities Act guidelines and ANSI A117.1 requirements for accessible and usable building facilities-check local codes



TOILETS/LAVS

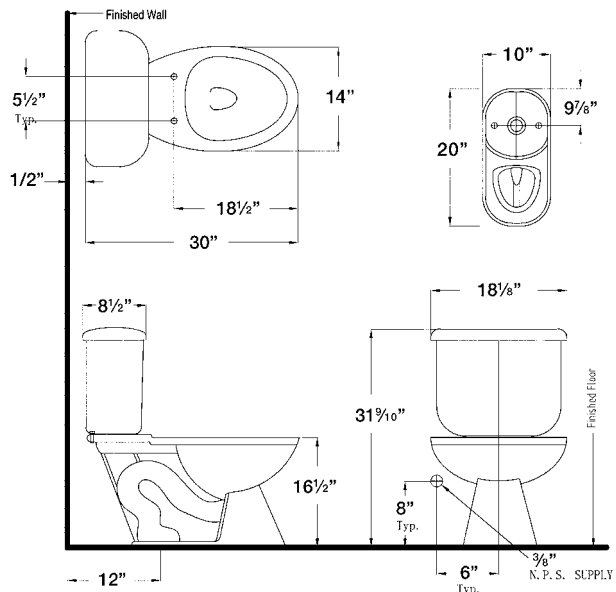

This toilet is designed to rough-in at a minimum dimension of 305mm (12") from finished wall to C/L of outlet. Supply not included with fixture and must be ordered separately. Dimension shown for location of supply is suggested. For additional information refer to installation instructions supplied.